

## Neotech Bridge<sup>®</sup>

### BREASTFEEDING ASSISTANCE DEVICE

A simple, controlled way to supplement at the breast and support the breastfeeding journey.

## How is the Bridge different?

### Simple set up

No tape or tubing manipulation common with a traditional Supplemental Nursing System (SNS).

### Precise flow control

Supplement only flows when the user gently presses the syringe. **This is an intentional design to allow for complete control over timing, rate, and amount of supplement delivered.**

### No flow dependency

Unique one-way valve allows supplement to flow into the chamber, but never backward or passively into baby's mouth to prevent flow preference.

### Thin soft silicone cover

sits gently on the breast and forms a small chamber at the tip, where milk is delivered from a syringe.

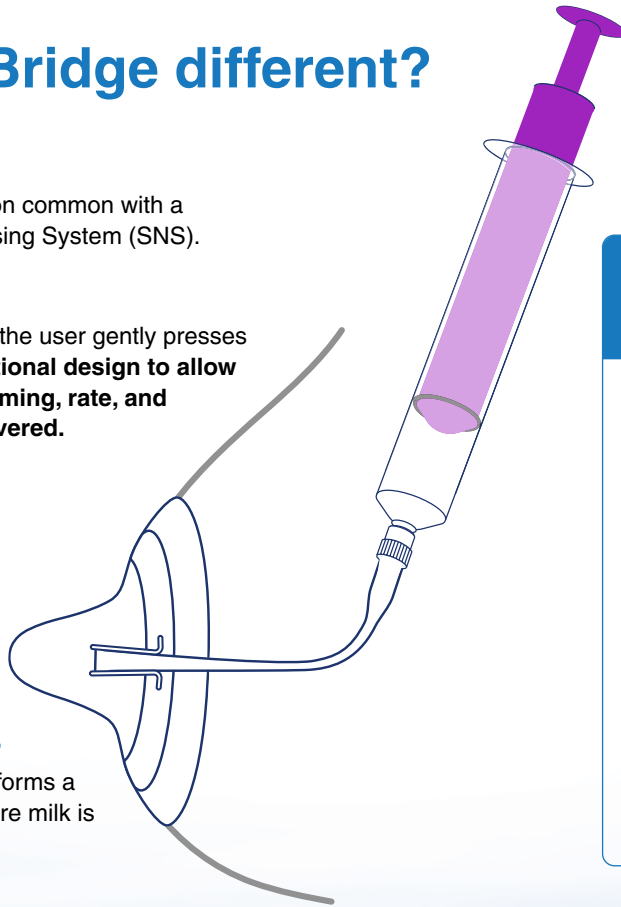

### Why use the Bridge before the bottle?

**Baby stays engaged at the breast** to access milk, helping reinforce latch behaviors.

**Baby continues suckling and coordinating naturally** rather than adapting to a faster, artificial flow.

**Parents can supplement without disrupting breastfeeding.** Parents can avoid reliance on bottles or bottle preference.

**Supports transition back to breast.**

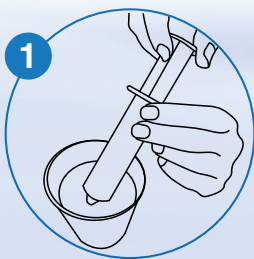

1 Fill syringe with breastmilk or formula

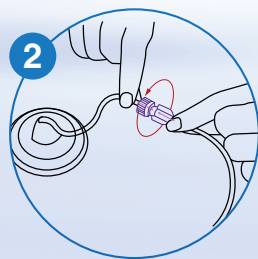

2 Twist onto the purple Neotech Bridge connector



3 Invert the Bridge and center over the nipple

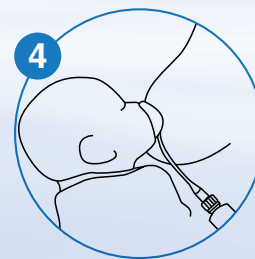

4 Latch the baby onto the Bridge

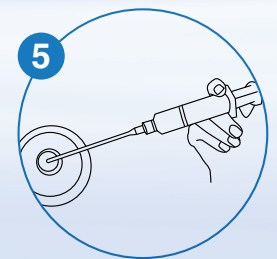

5 Gently depress syringe to deliver milk as needed



Scan for **FAQs**



**Stay informed:** Sign up for new Bridge sizes and clinical updates.